

City of Winkler

SCHEDULE "A"

To By-Law 1938-08

Being The City of Winkler Zoning By-Law.

ZONING CONSOLIDATION

LEGEND

- "RS" - Residential Single-Family Zone
- "RT" - Residential Two-Family Zone
- "RM" - Residential Multiple-Family Zone
- "RMA" - Res. Restricted Multi-Family Zone
- "RMH" - Residential Mobile Home Zone
- "RR" - Rural Residential Zone
- "RC" - Residential Comprehensive Zone
- "LCR" - Limited Commercial Residential Zone
- "CC" - Commercial Central Zone
- "CL" - Commercial Linear Zone
- "CH" - Commercial Highway Zone
- "CS" - Commercial Shopping Centre Zone
- "CN" - Commercial Neighbourhood Zone
- "CRI" - Commercial Residential Institutional Zone
- "OR" - Open Space / Recreation Zone
- "I" - Institutional Zone
- "MG" - Industrial General Zone
- "MB" - Industrial Business Zone
- "MR" - Industrial Restricted Zone
- "CR" - Community Reserve Zone
- "SL" - Sensitive Land Zone

- Limits of the Zone
- City Boundary
- Airport Restriction Zone

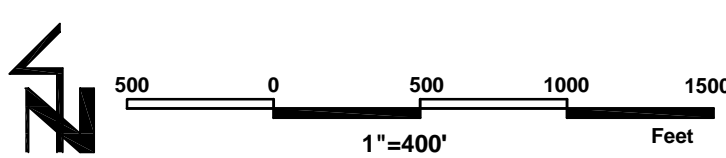
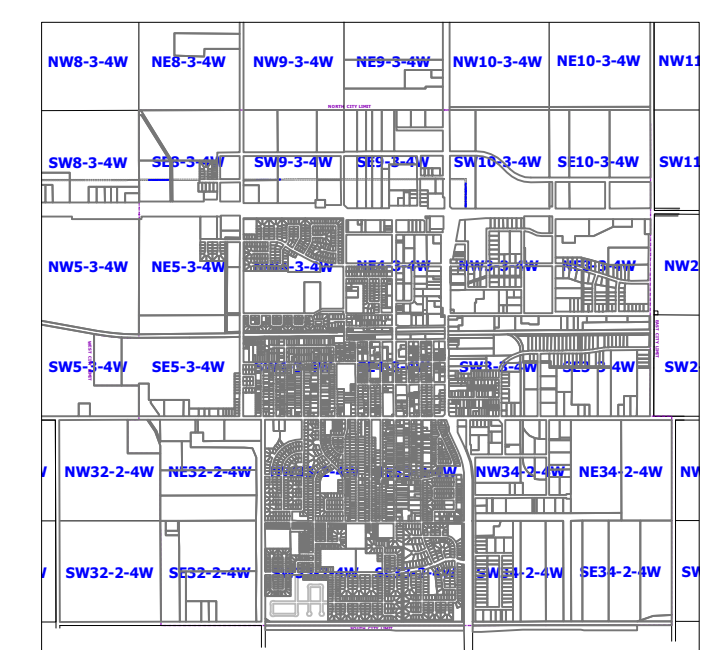

All Rights Reserved. Copyright © 2008, City of Winkler.



REVISED To: AUGUST 2008 DRAWING No. ZBL1938-08-03

DISCLAIMER:
 This map is not for resale.
 The City of Winkler does not guarantee this map to be free of any errors.
 This map is to be used for study purposes only.
 This map is not a legal document and is subject to change.

